

SPIT SDI 145 / SDI 185

LITHIUM LITHIUM



	SDI 145 LITHIUM Ref. 054271 14,4V LITHIUM	SDI 185 LITHIUM Ref. 054274 18V LITHIUM
Nm (ISO 5393)	50/15 Nm max. ● n ₀ = 0-450 min ⁻¹ ● n ₀ = 0-1450 min ⁻¹	56/26 Nm max. ● n ₀ = 0-500 min ⁻¹ ● n ₀ = 0-1600 min ⁻¹
Weight	1,5 kg	1,8 kg
Drill Bit	Ø max. 13 mm Ø max. 7 mm Ø max. 28 mm	Ø max. 13 mm Ø max. 8 mm Ø max. 32 mm
EN 60 745	L _{wA} = 80 dB(A) L _{pA} = 71 dB(A) K = 3 dB(A)	a _s ≤ 2,5 m/s ² K = 1,5 m/s ²
Battery	Ref. 054282 14,4V LITHIUM 1,3Ah 18,7Wh	Ref. 054284 18V LITHIUM 2,6Ah 46,8Wh
Charging Time	32'	65'
Power	Ref. 054286 230V - 50/60 Hz 50W 14,4V - 18VDC 2A	45°C 0°C





SDI 145 / SDI 185

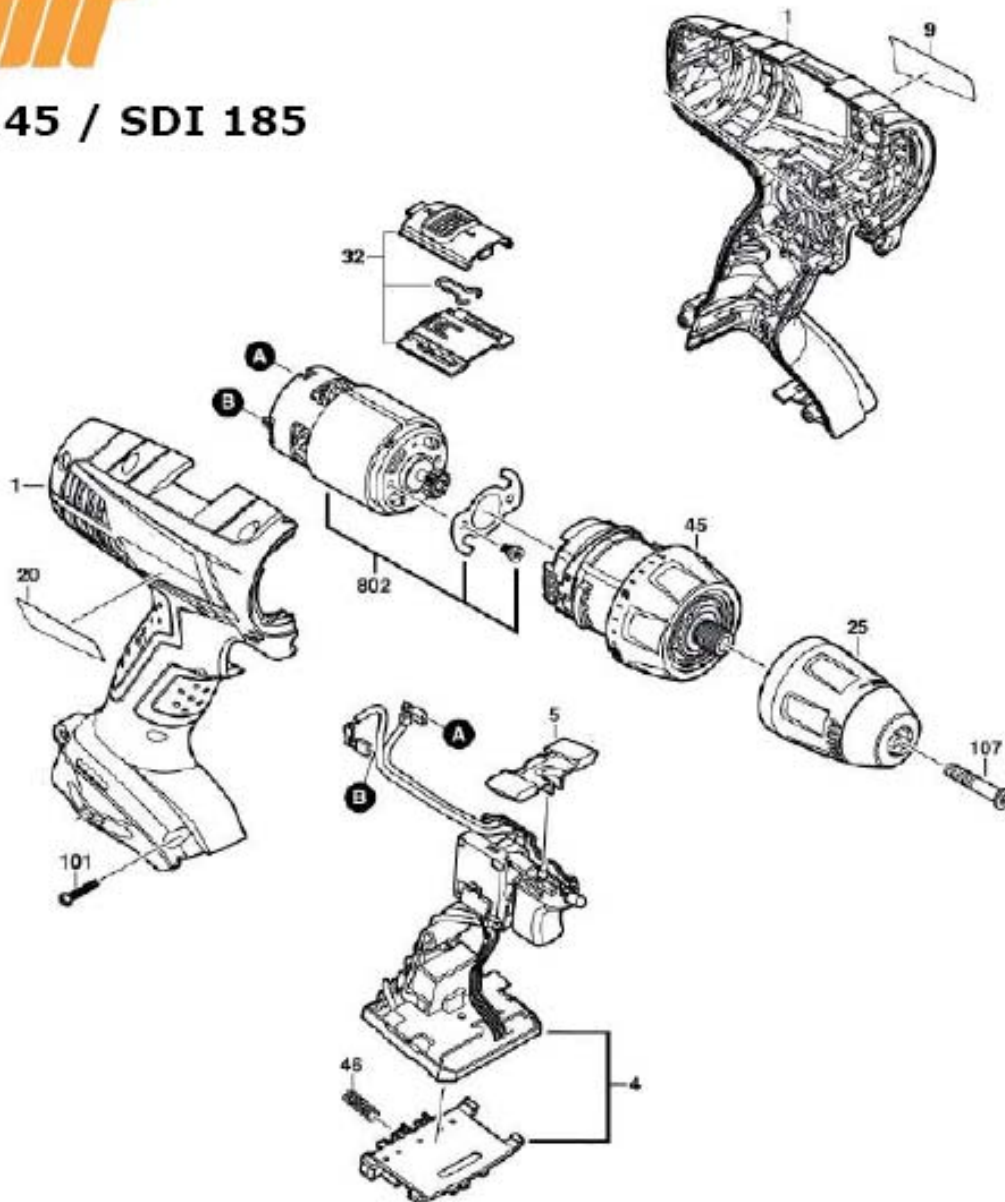

Plan	SDI 185Li	SDI 185L1	Omschrijving
1	652655	652655	Huis L&R.
4	652682	652628	Electronische module
5	652657	652657	Omkeer schakelaar
9	652683	652677	Linker label
20	652684	652678	Rechter label
25	652662	652662	Boorkop
32	652663	652663	Toerental regeling
45	652685	652680	Tandwielkast
46	652665	652665	Veer
101	652431	652431	Schroef
107	652498	652498	Borgschroef boorkop
802	652686		Motor 14,4 V.
802		652686	Motor 18,0 V